



Keeping the World Flowing
for Future Generations

IB Range

Multi-turn cast iron
housing gearboxes

IB Range multi-turn operators have been designed with customer stocking in mind, and features a removable output sleeve to facilitate spindle machining.

Rotork series IB operators are multi-turn devices intended for the operation of gate, globe, sluice and penstock valves. These gearboxes are designed for motorised applications.

Operating temperature normally ranges from -40 to +120 °C (-40 to +250 °F), although other temperature ranges are available on request.

Standard input and output flanges are to ISO 5210 (metric) MSSP-102 (imperial). DIN output flanges can be supplied.

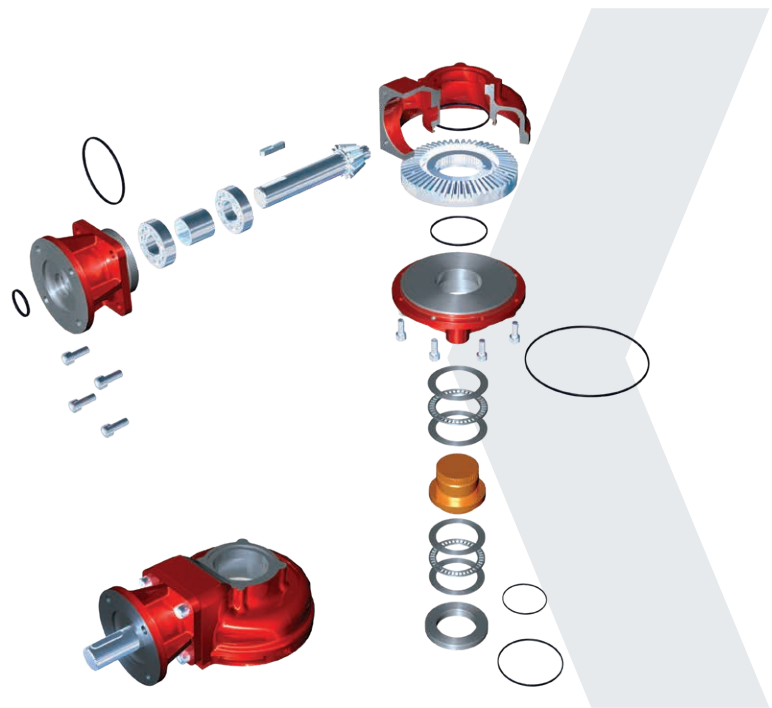
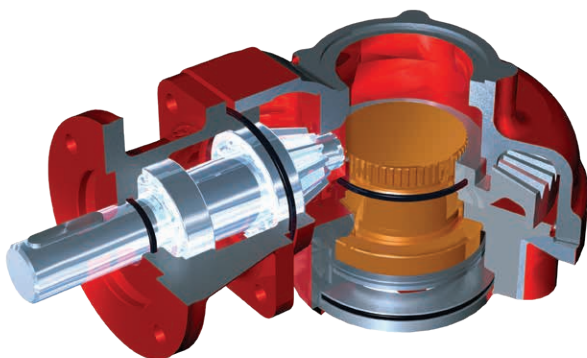

Features

- Totally enclosed gearing
- Grease filled for life and fully sealed
- Comprehensive gear ratios
- Removable output sleeve
- Spur and bevel combinations available
- Input gear mounted on ball bearings
- Various input and output flanges to suit actuators and valves

Environmental specification

- Enclosure IP67 standard suitable for submerged duty up to a depth of 1 metre (3 feet) for 30 minutes
- Enclosure IP68 continuous submerged duty up to a maximum depth of 15 metres (50 feet)

Options

- Auxiliary spur/bevel input reducers
- High and low temperatures
- IP68, buried duty
- Flexible extensions
- Dual shaft bevel – 2 or 3 input shafts available at 90° and 180° to each other
- Firesafe to ISO 10497
- Interlock safety system
- Form A, B and C available

IB Range

Multi-turn cast iron housing gearboxes

Gearbox selection chart

| Gearbox | Nominal ratio | | Output torque | | Max thrust | | Mechanical advantage ±10%* | |
|---------|---------------|---|---------------|----------|------------|-------------|-------------------------------|------|
| | | | (Nm) | (lbf.ft) | (kN) | (lbf x1000) | | |
| IB2 | 1 | | 306 | 225 | 53 | 12 | 0.85 | |
| IB3 | 1 | | 306 | 225 | 177 | 40 | 0.85 | |
| IB4 | 2 | | 306 | 225 | 53 | 12 | 1.70 | |
| IB4 | 3 | 4 | 678 | 500 | 53 | 12 | 2.55 | 3.40 |
| IB4 | 6 | | 542 | 400 | 53 | 12 | 5.10 | |
| IB5 | 2 | | 306 | 225 | 177 | 40 | 1.70 | |
| IB5 | 3 | 4 | 678 | 500 | 177 | 40 | 2.55 | 3.40 |
| IB5 | 6 | | 542 | 400 | 177 | 40 | 5.10 | |
| IB6 | 3 | 4 | 1355 | 1,000 | 177 | 40 | 2.55 | 3.40 |
| IB6 | 6 | | 1084 | 800 | 177 | 40 | 5.10 | |
| IB7 | 3 | 4 | 1355 | 1,000 | 266 | 60 | 2.55 | 3.40 |
| IB7 | 6 | | 1084 | 800 | 266 | 60 | 5.10 | |
| IB8 | 3 | 4 | 2033 | 1,500 | 266 | 60 | 2.55 | 3.40 |
| IB8 | 6 | | 1627 | 1,200 | 266 | 60 | 5.10 | |
| IB9 | 3 | 4 | 2033 | 1,500 | 355 | 80 | 2.55 | 3.40 |
| IB9 | 6 | | 1627 | 1,200 | 355 | 80 | 5.10 | |
| IB10 | 4 | 6 | 4067 | 3,000 | 355 | 80 | 3.40 | 5.10 |
| IB11 | 4 | 6 | 4067 | 3,000 | 500 | 113 | 3.40 | 5.10 |
| IB12 | 6 | 8 | 8135 | 6,000 | 500 | 113 | 5.10 | 6.80 |
| IB13 | 6 | 8 | 8135 | 6,000 | 834 | 188 | 5.10 | 6.80 |
| IB14 | 6 | 8 | 8135 | 6,000 | 1320 | 297 | 5.10 | 6.80 |

Static safety factor is 2 (torque).

*The published M.A. is achieved after a few cycles.

For detailed IB Range information refer to PUB030-001 (metric) and PUB030-002 (imperial).

Contact us now

mail@rotork.com

www.rotork.com

rotork[®]

PUB030-019-00

Issue 05/26